



Gauge Serie 6300 MAGNETEL™

APPLICATION :

The 6300 series, Magnetel gauges are used to indicate level of liquefied gases such as LPG, Ammonia, petrochemical, chemical liquids, refrigerants, fuels, etc.

The Magnetel gauges are designed to be used on tanks with diameter up to 5000 mm and pressure up to 25 bar at temperature -20°C to $+65^{\circ}\text{C}$ (40 bar with Stainless Steel head).

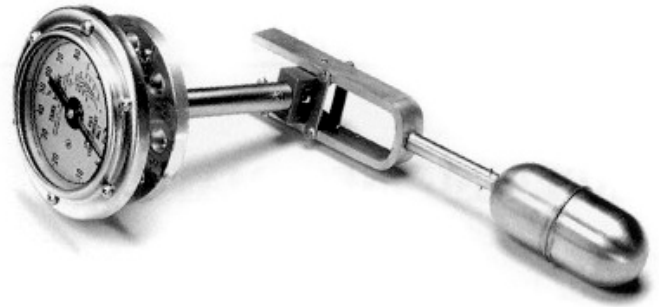

CONSTRUCTION MATERIAL:

The construction material is specified by a number (TRIM N°) which should be specified as a suffix to the model number.

TRIM	HEAD	Support Center shaft Float arm	Counter balance	Magnet	Gears	Gasket	Application
00	Aluminium ASA - DIN	Stainless Steel	Zinc Platted Steel	AlNiCo	Stainless Steel	Not Supplied	LPG, Ammonia
08	Aluminium	Stainless Steel	Zinc Platted Steel	AlNiCo	Stainless Steel	BUNA N	LPG, Ammonia, Fuels
09	Stainless Steel	Stainless Steel	Stainless Steel	AlNiCo	Stainless Steel	Teflon filled 304 SS spiral wound	Petrochemicals, Chemicals
11	Stainless Steel	Stainless Steel	Zinc Platted Steel	AlNiCo	Stainless Steel	Teflon filled 304 SS spiral wound	Refrigerants, Chemicals, LPG, Amonia
12	Stainless Steel	Stainless Steel	Stainless Steel	AlNiCo Enclosed in 316 SS cup	Stainless Steel	Teflon filled 304 SS spiral wound	Petrochemicals, Chemicals
16	Stainless Steel 316	Stainless Steel 316	Stainless Steel 316	AlNiCo Enclosed in 316 SS cup	Stainless Steel 316	Teflon	Petrochemicals, Chemicals

MOUNTING : (8) Mounting studs.

Head type	Material	Stud size	Bolt circle
Rochester standard	Alu. or S.S.	1/2"-13UNC or M12	89mm
ASA 300Lbs R.F.3"	Aluminium	M20 (*)	168mm
DIN DN 80 PN 25	Aluminium	M16 (*)	160mm

(*) Magnetel supplied with ASA or DIN Head are supplied without gasket and Mounting Studs/Nuts.

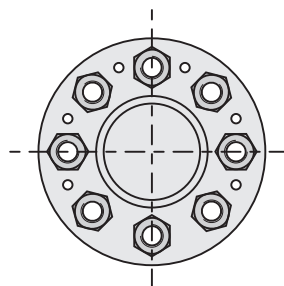

Centerline Mount

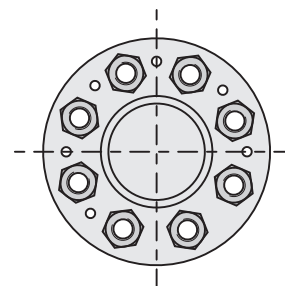

Straddle Mount

When ordering a straddle mounted magnetel add suffix X to model number.



ROCHESTER GAUGES INTERNATIONAL S.A.

Z.I. WAVRE NORD - Av. Lavoisier, 6 - 1300 WAVRE (Belgium)

Tel. +32 (0)10 241010 - Fax +32 (0)10 228139

<http://www.rochester-gauges.be>

MODEL NUMBER :

Model Number	Mounting Position	Dial Size
6336- Trim N°	TOP	100mm (4")
6339- Trim N°	End/Side or Angle	100mm (4")
6342- Trim N°	End/Side or Angle	200mm (8")
6360- Trim N°	TOP	200mm (8")

ORDERING INFORMATION :

1) For horizontal cylindrical tank

- Model number
- Mounting position
Top, side
For angle mounting, tank drawing requested
For end mounting, specify shape of tank dish end
- Tank outside and inside diameter
- Riser dimension (distance between gauge gasket and tank wall)
- Product to be gauged
- Working pressure and temperature
- Tank design pressure
- Mounting Bolts Position

2) For other type of tank

- Same information as in 1
- Tank drawing

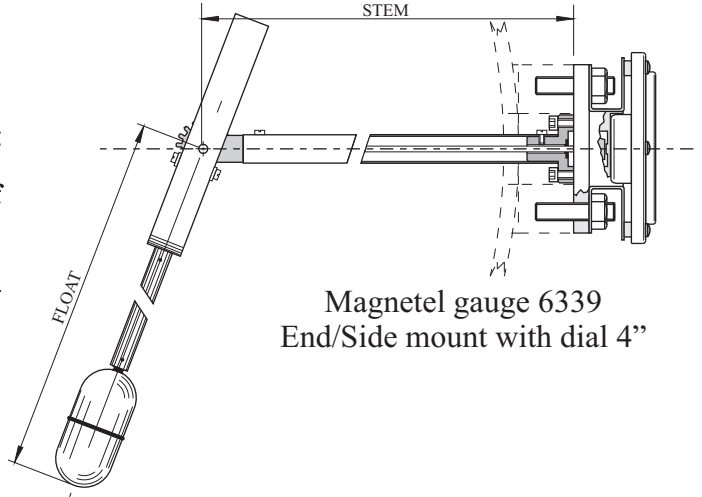

Magnetel gauge 6339
End/Side mount with dial 4"

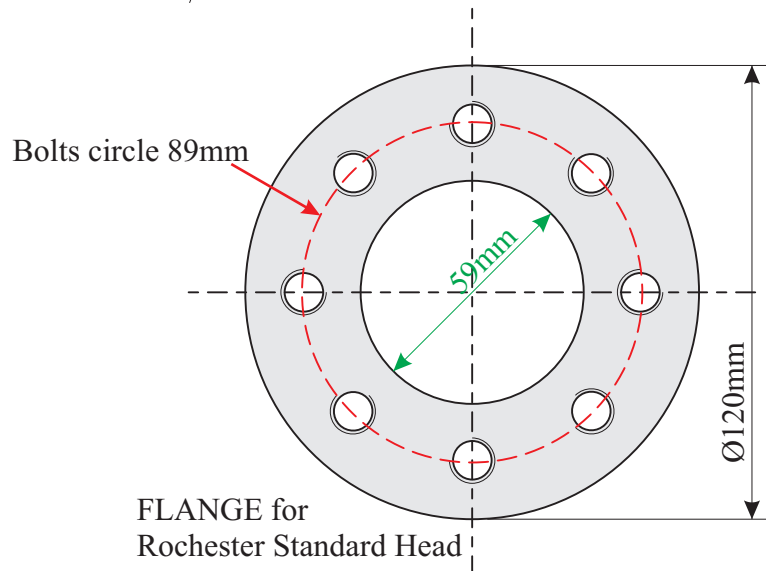

CERTIFICATION :

Those gauges serie 6300 "Magnetel" are in accordance with European Directive PED 97/23/CE for

- LPG, ammonia for maximum pressure 25 bar and temperature -20° to + 60°C
- CO2 for maximum pressure 40 bar and temperature -40° to + 5°C
- Others : on request after risk analysis.

They have been certified by APRAGAZ, notified body 0029, under n° 02/BE/329
For Mobile application (TPED certified) refer to M6300 leaflet.